

▼ Shown: FS-56



- Lightweight, ergonomic design for ease of use
- Adjustable jaw widths from 2.75" to 8.50" for a wide range of applications
- Single-acting, spring return RC Series cylinders for fast trouble-free operation

FS, STF Series



Capacity:
5-10 tons

Spread:
2.75 - 8.50 inches

Maximum Operating Pressure:
10,000 psi

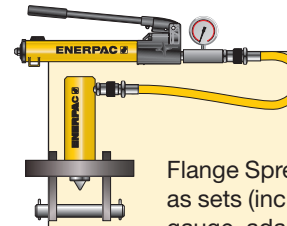

Flange Spreader Sets*

Both Hydraulic Flange Spreaders are available as sets (includes pump, tool, gauge, adaptor and hose).

Set Model Number	Spreader Model Number	Pump Model Number
STF-56H	FS-56	P-392
STF-109H	FS-109	P-392
STF-109A	FS-109	PATG-1102N



Wedge Spreaders

Friction-free, smooth and parallel wedge movement with unique interlock wedge design. Eliminates flange damage and risk of spreading arm failure.

Page: 255

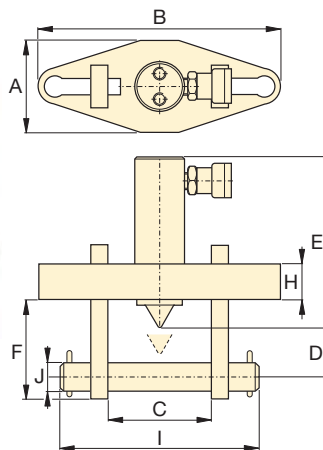
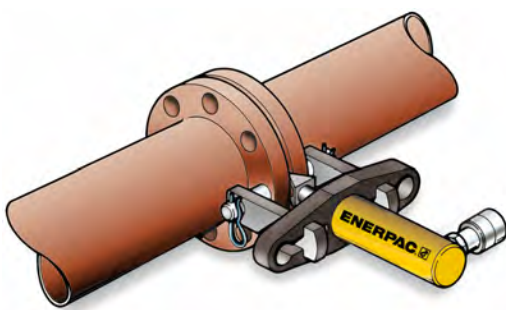

Flange Spreader Matching Chart

ASA Rating (psi)	Pipe Size (in)	
	FS-56	FS-109
150	5-20	22-42
300	2.50-14	16-28
400	2.50-12	14-24
500	2.50-10	12-20
900	.50-6	8-16
1500	.50-3.50	4-8
2500	.50-2.50	3-4

Maximum Flange Thickness (in)	Stud Size (in)	Standard Wedge (in)	Cap. (ton)	Stroke (in)	Oil Cap. (in ³)	Model Number	Dimensions (in)										Weight (lbs)
							A	B	C		D	E	F	H	I	J	
									Min.	Max.							
2 x 2.25	.75-1.13	.13-1.13	5	1.50	1.50	FS-56*	3.00	8.25	2.75	6.10	1.28	7.71	3.45	1.00	8.10	.75	26
2 x 3.63	1.25-1.63	.13-1.13	10	2.13	4.80	FS-109*	4.25	11.00	4.10	8.50	1.98	6.00	4.50	1.50	10.75	1.25	40

* Available as Tool-Pump Set, see note on this page.

Hydraulic and Mechanical Industrial Spreaders

▼ Shown: FSH-14 and FSM-8 with safety blocks SB1



- Integrated wedge concept: friction-free, smooth, parallel wedge movement eliminates flange damage and spreading arm failure
- Unique interlocking wedge design: no first step bending and risk of slipping out of joint
- Requires very small access gap of only .24 inch (6 mm)
- Stepped spreader arm design: each step can spread under full load
- Few moving parts means durability and low maintenance
- Safety block SB-1 and ratchet spanner SW-22 included with FSM-8
- Safety block and Enerpac RC-102 cylinder included with FSH-14

FSM/FSH/STF Series

Tip Clearance / Maximum Spread*:
0.24/3.16 inches

Maximum Spread Force:
8-14 tons

Maximum Operating Pressure:
10,000 psi (FSH-14)

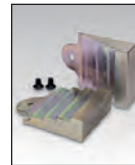

Stepped Blocks FSB-1

Use this pair of stepped blocks to increase wedge opening up to 3.16 in. (81 mm). Fits both FSH-14 and FSM-8.

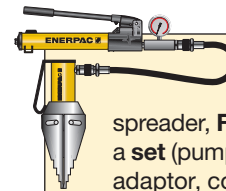

Flange Spreader Sets

The hydraulic flange spreader, FSH-14, is available as a set (pump, tool, gauge, gauge adaptor, couplers and hose) for your ordering convenience

Spreader Model No.	Handpump Model No.	Set Model Number
FSH-14	P-392	STF-14H

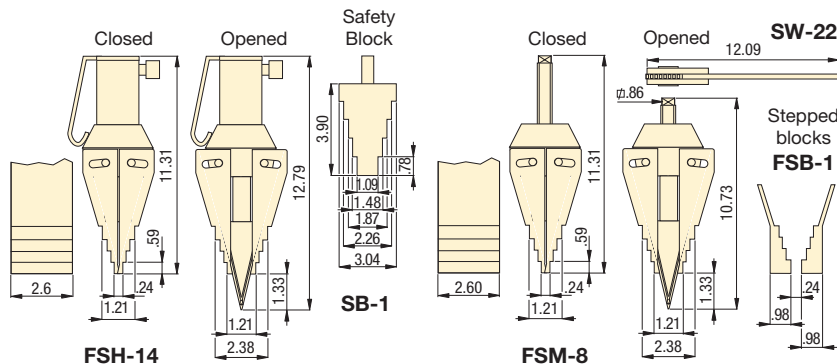

Max. Spreading Force (ton)	Model Number	Tip Clearance (in)	Max. Spread ¹⁾ (in)	Type	Oil Capacity (in ³)	Weight (lbs)
8	FSM-8	.24	3.16	Mechanical	-	14.3
14	FSH-14*	.24	3.16	Hydraulic	4.76	15.7

¹⁾ Using stepped blocks FSB-1.

* Available as Tool-Pump Set, see note on this page.

▼ Two FSH-14 spreaders used simultaneously with Enerpac handpump, hoses and AM-21 split-flow manifold.

